

MANHOLE FRAME AND COVER SHALL CONFORM TO SECTION 02605 (2.13) MANHOLE FRAMES AND COVERS WATERTIGHT COVERS SHALL BE USED IF REQUIRED BY THE AUTHORITY

CONE CAST WITH 4 ANCHORS FOR 3/4" BOLTS.(SEE DWG.#4)

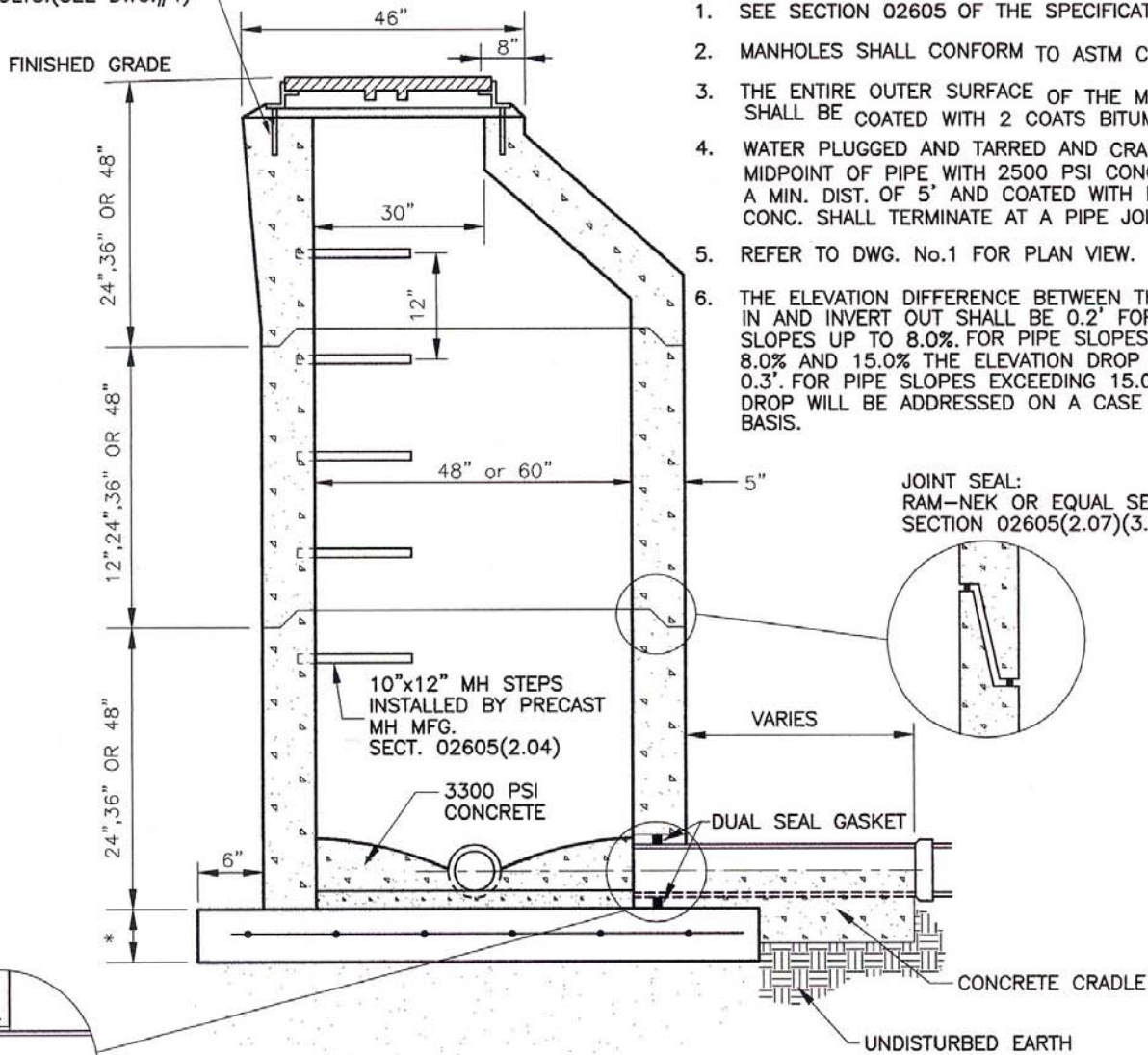

NOTES:

1. SEE SECTION 02605 OF THE SPECIFICATIONS
2. MANHOLES SHALL CONFORM TO ASTM C-478.
3. THE ENTIRE OUTER SURFACE OF THE MANHOLE SHALL BE COATED WITH 2 COATS BITUMASTIC.
4. WATER PLUGGED AND TARRED AND CRADLED TO MIDPOINT OF PIPE WITH 2500 PSI CONC. FOR A MIN. DIST. OF 5' AND COATED WITH BITUMASTIC. CONC. SHALL TERMINATE AT A PIPE JOINT.
5. REFER TO DWG. No.1 FOR PLAN VIEW.
6. THE ELEVATION DIFFERENCE BETWEEN THE INVERT IN AND INVERT OUT SHALL BE 0.2' FOR PIPE SLOPES UP TO 8.0%. FOR PIPE SLOPES BETWEEN 8.0% AND 15.0% THE ELEVATION DROP SHALL BE 0.3'. FOR PIPE SLOPES EXCEEDING 15.0% THE DROP WILL BE ADDRESSED ON A CASE BY CASE BASIS.

JOINT SEAL:
RAM-NEK OR EQUAL SEALS
SECTION 02605(2.07)(3.03)

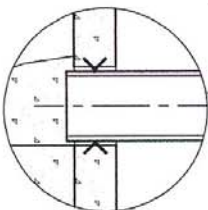

A-LOK GASKET WATERSTOP PER ASTM C923
CAST INTEGRALLY IN MANHOLE
WALL JOINT ALLOWS 10"
OMNIDIRECTIONAL DEFLECTION
SECTION 02605(2.06)

***BASE THICKNESS**
2"-15"PIPE-8"
18"-27"PIPE-12"
30"-UP--DESIGN

STANDARD DETAIL

**TYPICAL MANHOLE SECTION A-A
PRECAST BASE & WALL SECTIONS**

NOT TO SCALE | 06/01 | DWG. NO.2